

**BLINDS TO GO**  
DIRECT FROM OUR FACTORY

# Harmony Ripple-Fold Drapery Installation Guide



**We make it easy!**

BTG 574715

CAEN Rev. 05-22

## WARNING

**STRANGULATION HAZARD:** Young children can be strangled by cords. Immediately remove this product if a cord longer than 22 cm or a loop exceeding 44 cm around becomes accessible.

### Before Starting

Please read through all instructions carefully before you begin.

Unpack all materials making sure all components are included:

- Track(s)
- Master carrier(s) & carriers (pre-installed within track)
- Mounting brackets
- Splice, if requested

### Tools You Will Need:

- Drill with a 1/8" bit and a Phillips bit
- Phillips screwdriver
- Screws for mounting brackets
- Metal tape measure
- Hack saw (optional)

### Wall Mount Instructions:

#### Installing Your Drapery Track:

You are now ready to install your Forest Drapery Track System.

#### 1. Measure

Determine the height of the top of track and mark bracket height on the wall for all the brackets and adjust (as necessary) to make sure they are all leveled.

#### 2. Mark

Measure the width of the track and mark the two end brackets approximately 3"- 4" in from the ends of the track. Evenly space the remaining brackets and place corresponding marks.

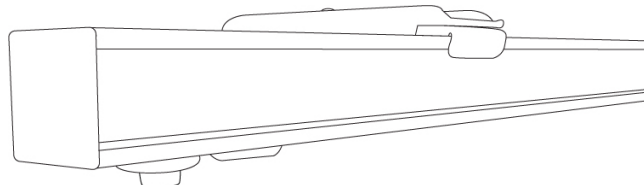

#### 3. Mount

To attach the bracket to the wall; first pre-drill holes for screw diameter when mounting into wood frame of window or wall stud. Otherwise, pre-drill and install anchors first before fastening with screws.

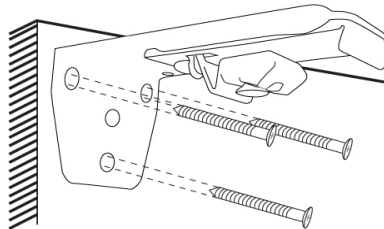

#### 4. Attach Bracket

Place the track into the bracket as shown in the drawing; applying pressure until track "clicks" into bracket. Make sure track set screw is loose enough to allow the track retainer to flex. Repeat this step for the remaining brackets.

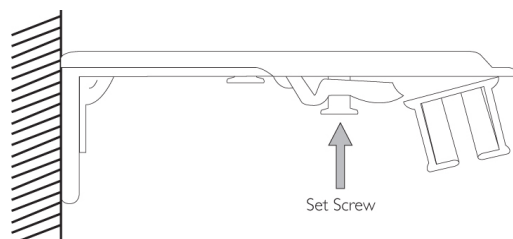

## 5. Tighten

Tighten track set screws on all the brackets to secure track to brackets.

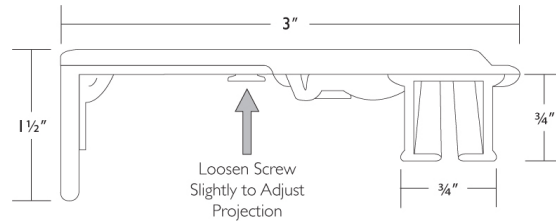

## 6. Adjust Projection

Adjust track to the desired projection. Projection is adjustable from 3" – 4 1/2". Repeat this step for the remaining brackets.

Once desired projection is set for all the brackets, lock the bracket into position by tightening the track depth adjustment set screw (see drawing below).

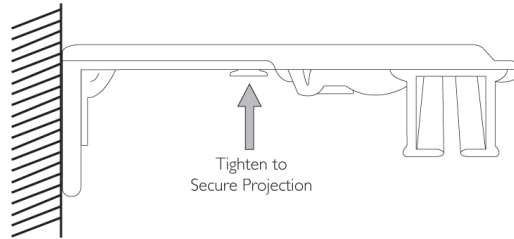

## Installing Splice, if requested:

For wide areas, tracks will be shipped in multiple pieces and will require a splice.

- Slide the track of the connecting ends on each track into the channel of the splice and butt ends together.
- Tighten locking screw with hex key for a secure fit.

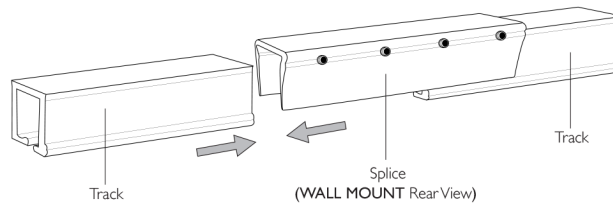

## Ceiling Mount Instructions:

### Installing Your Drapery Track:

You are now ready to install your Forest Drapery Track System.

#### 1. Measure

Measure the width of the track and mark the two end brackets approximately 3" - 4" in from the ends of the track. Evenly space the remaining brackets and place corresponding marks.

#### 2. Mount

To attach the bracket to the ceiling; first pre-drill holes for screw diameter when mounting into wood frame of window or wall stud. Otherwise, pre-drill and install anchors first before fastening with screws.

### 3. Attach Bracket

Place the track into the bracket as shown in the drawing; applying pressure until track “clicks” into bracket. Make sure track set screw is loose enough to allow the track retainer to flex. Repeat this step for the remaining brackets.

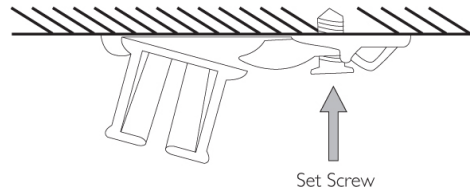

### 4. Tighten

Tighten track set screws on all the brackets to secure track to brackets.

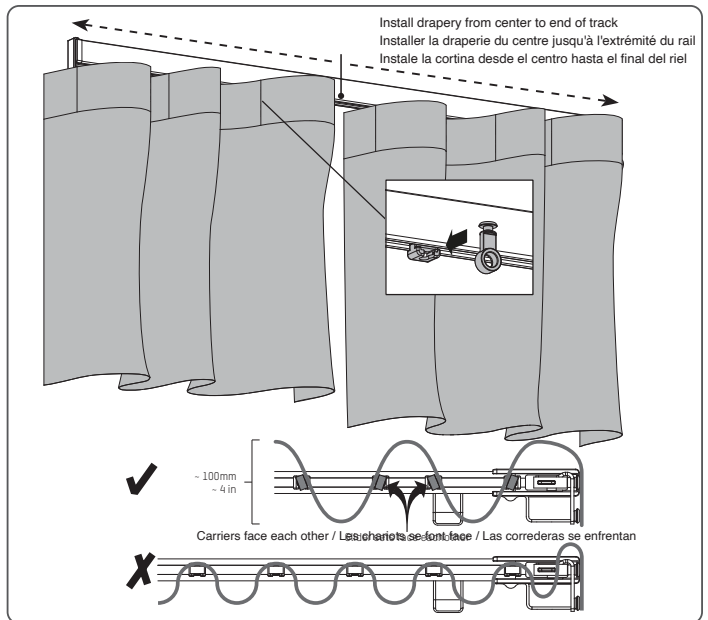
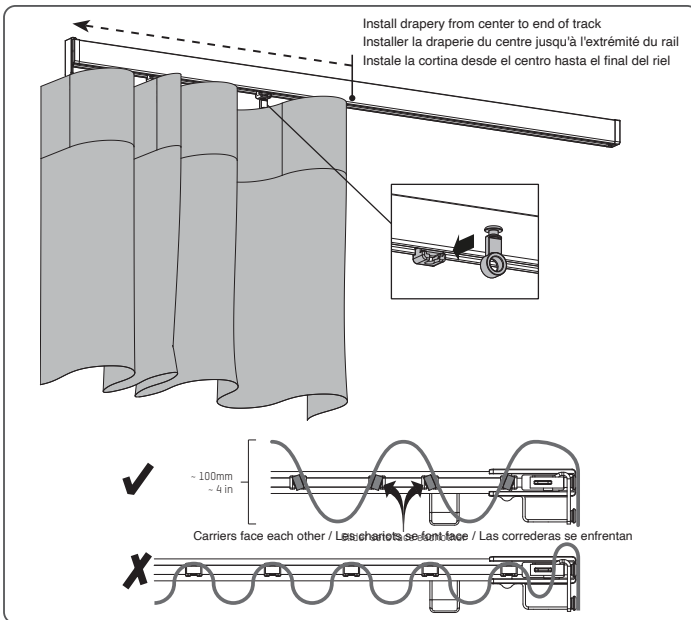
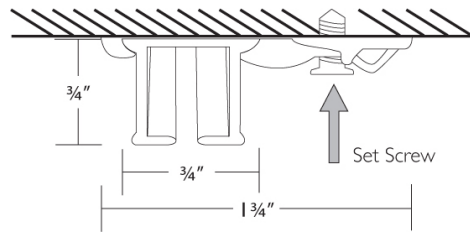

### Installing Drapery Wand: (Wand Control Only)

You may attach a wand(s) to the master carrier(s). Simply fit the metal hook on the wand through the slot on the master carrier



### Installing Drapery Side Return:

Attach the side return hook on the wall over the screw provided.

